

PORODO
LIFESTYLE



Porodo Lifestyle
EMS and RED Light Hair
Oil Applicator

SKU:PD-LFST125

Table of Contents

Schematic View	2
Product Description	3
Instructions for Use	3
Important Tips	5
Specifications	5
Package Contents	5
Precautions	6
Disposal	6
Warranty	7
Contact Us	7

Schematic View

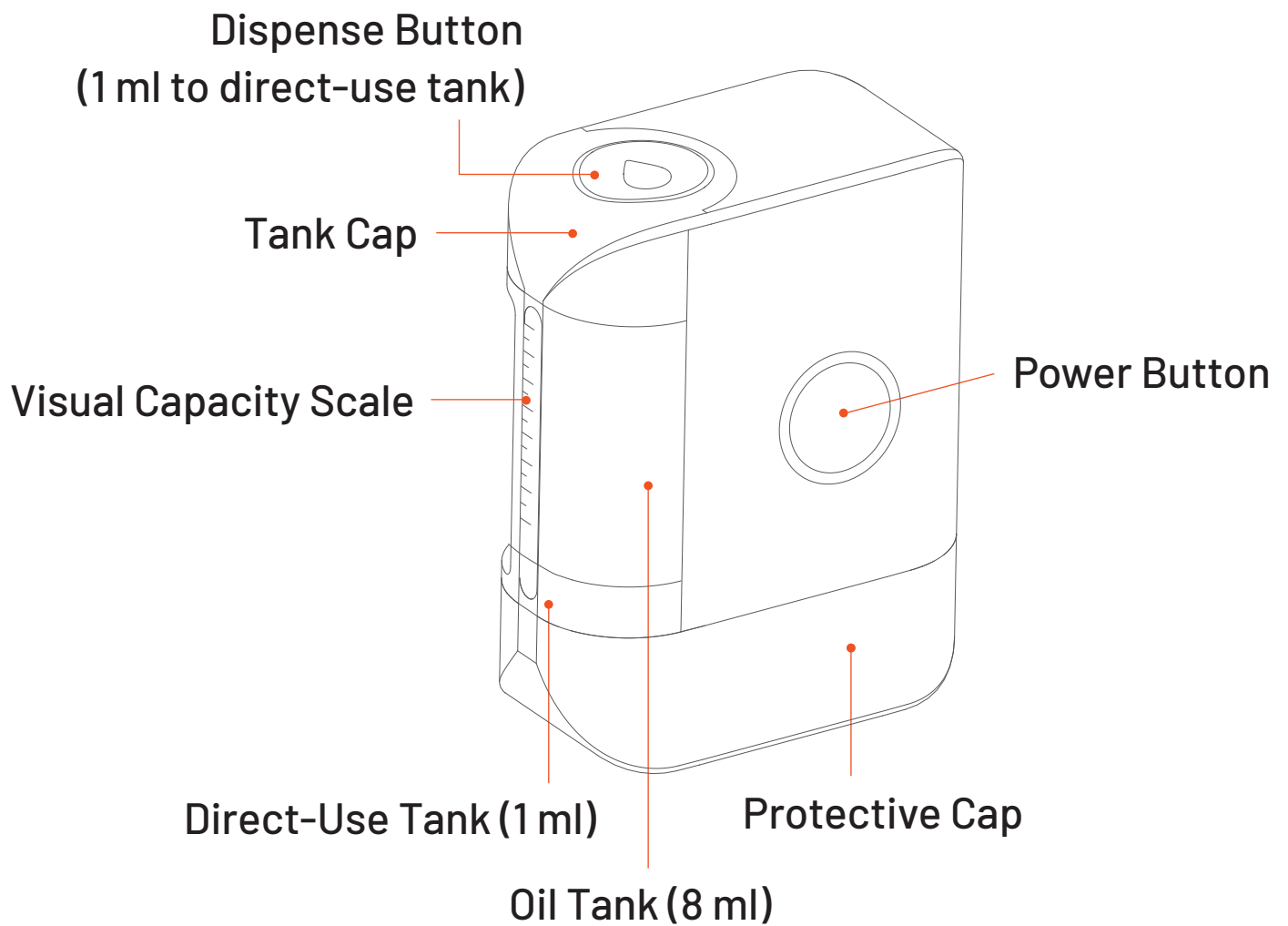
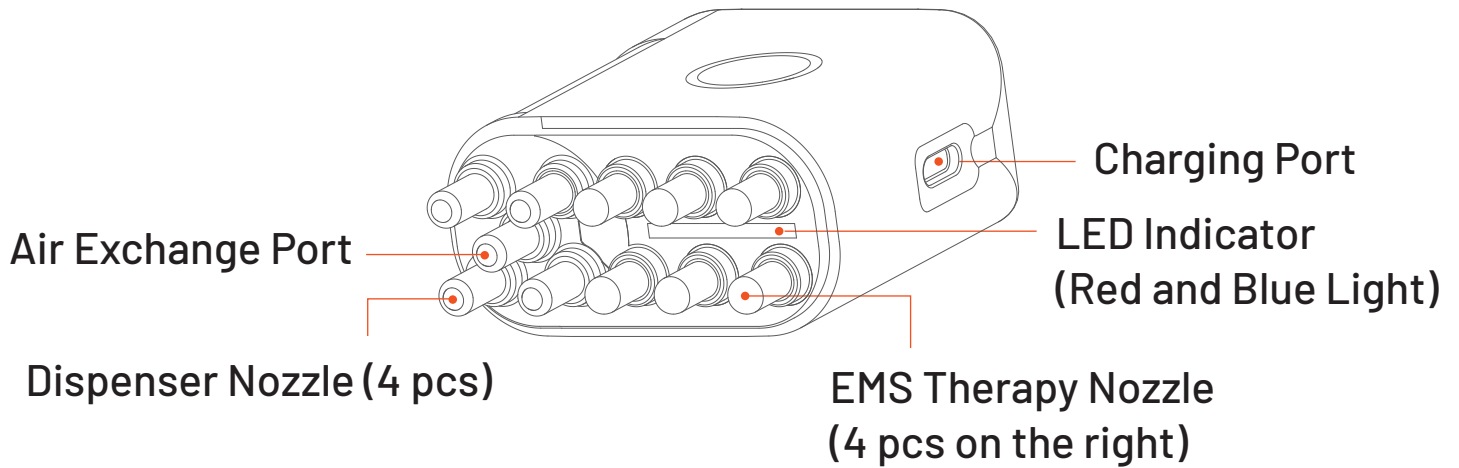

Product Description

1. Designed with a smooth, retractable ball-tipped dispenser that naturally parts the hair and conforms to the scalp, this brush evenly distributes hair oil at the roots while stimulating the scalp and hair follicles.
2. Thanks to the larger dispenser nozzles, the brush enables smoother and more efficient oil dispensing.
3. Pressing the button on the tank dispenses 1 ml of oil into the direct-use tank, ensuring user-friendly and precise dosage.
4. Equipped with a removable tank for convenient filling and cleaning.
5. Offers two selectable modes: Hair Nourishing Mode and Hair Renewal Mode.
6. Effectively soothes the scalp and promotes hair follicle health, serving as a convenient hair care tool at your fingertips.

Instructions for Use

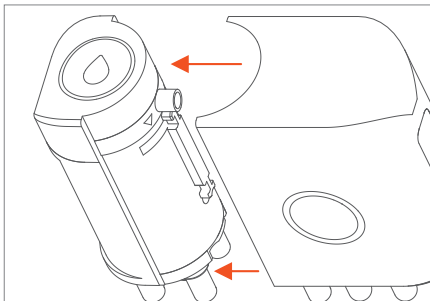

1. Remove the tank cap, then gently pinch the tank and pull it outward to detach it from the main unit.

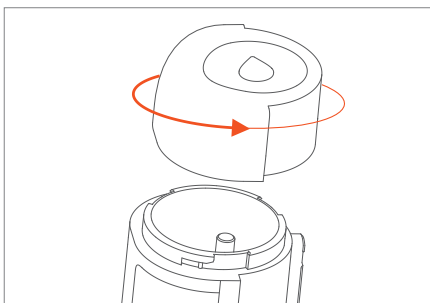

2. Twist the tank cap counterclockwise from CLOSE to OPEN.

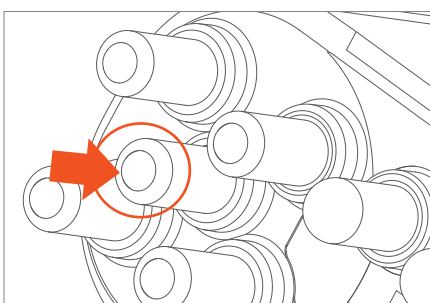

3. Fill the tank with hair solution (maximum 8 ml), then securely close the cap. If high air pressure in the direct-use tank causes the solution to overflow during use, press the air exchange nozzle to release pressure.

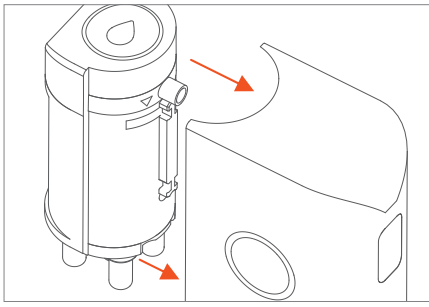

4. Reinstall the tank onto the main unit. Gently press it into place until a 'click' sound is heard, indicating proper attachment.

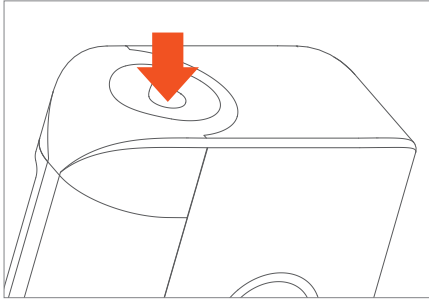

5. Press the button to dispense 1 ml of solution into the direct-use tank. Release the button once the tank is filled.

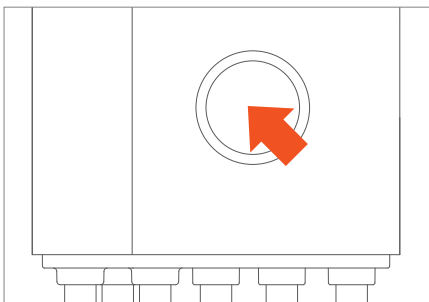

6. Long press the power button to power the device on or off.

After turning on the device, short press the power button to switch between modes and select the desired setting:

- Hair Nourishing Mode: Red light therapy, vibration massage, EMS Level 1
- Hair Renewal Mode: Red and blue mixed light therapy, vibration massage, EMS Level 2

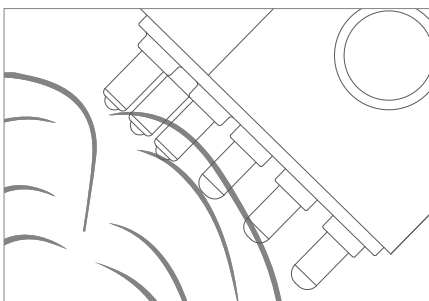

7. Hold the brush and allow the nozzles to come into contact with the scalp. Apply gentle pressure, then press and slide or tap to evenly distribute the solution across the scalp. After use, clean the brush, rinse the tank, and ensure it is completely dry before storage.

Important Tips

1. The device includes a 5-minute automatic shut-off function.
2. The LED indicator will flash when the battery is low. Please charge the device promptly.
3. While charging, the indicator light will remain red. Once fully charged, it will turn green.
4. The brush will stop working if the tank is detached from the main unit.

Specifications

Battery Capacity	150mAh
Working Voltage	3.7V
Charging Voltage	DC 5V
Tank Capacity	9ml
Charging Interface	Type-C
Water-Resistance Rating	IPX5
EMS Levels	2 Levels
Net Weight	91g
Product Size	28 x 70 x 55mm
Model Number	LFS125

Package Contents

1. Hair Oil Applicator
2. Charging Cable

Precautions

- 1.** Close the cap immediately after adding the solution. When storing, place the device on the protective cover of the comb.
- 2.** After the solution in the tank has been used, remove and clean the tank. Failure to do so may result in the residual solution evaporating and crystallizing, potentially blocking the dispenser nozzles and affecting the dispensing function.
- 3.** Avoid striking the dispenser nozzles with hard objects. Any deformation may impair the dispensing effect or cause irreversible damage.
- 4.** Keep the product out of reach of children.
- 5.** When the LED lights and vibration are noticeably weakened, indicating low power, charge the device promptly.
- 6.** When carrying the device, ensure the solution in the direct-use tank is empty.
- 7.** Always replace the charging port protective cap when carrying or cleaning the device.

Disposal

This product must not be disposed of as unsorted household waste. It is important to separate such waste for proper treatment and recycling, in compliance with local waste management regulations.



Warranty

Products that you buy directly from our **Porodo** website or shop come with a 24-month warranty.

When you buy **Porodo** products from any of our approved sellers, you only get a 12-month warranty. If you want to extend this warranty, go to our website at **porodo.net/warranty** and fill out the form with your information. Don't forget to upload a picture of the product too. After we've checked and accepted your request, we'll send you an email to confirm that your product's warranty has been extended.

For more info, please check:
porodo.net/warranty

Contact Us

If you have any questions about this Privacy Policy, please contact us at:
info@porodo.net

Website: **porodo.net**

Service Support: **support@porodo.net**

Instagram: **porodo**